

# FOR LEASE

5,791 Total SF  
\$0.41/SF NNN

**Brummett  
& COMPANY**  
14950 Heathrow Forest Parkway, Suite 100  
Houston, Texas 77032 Tel. 281-442-5404  
[LEASING@BRUMMETTANDCOMPANY.COM](mailto:LEASING@BRUMMETTANDCOMPANY.COM)



## TRANSCENTRAL BUSINESS PARK

16554 Air Center Blvd. Houston, TX 77032

### DETAILS

- Attractive flex-industrial park in Central Green area of North Houston, near IAH airport
- **No flooding during Hurricane Harvey**
- Easy access to I-45, Beltway 8 & Hardy Toll Rd.
- Privately patrolled

16554 Air Center Blvd. Features:

- 5,791 SF total ( $\pm$  40% of which is office)
- Clear Height: 18'
- Truck Doors: 1 dock, 1 semi, 1 ramp to grade
- Rate: \$0.41/SF NNN (+ OpEx = \$0.59/SF Gross)

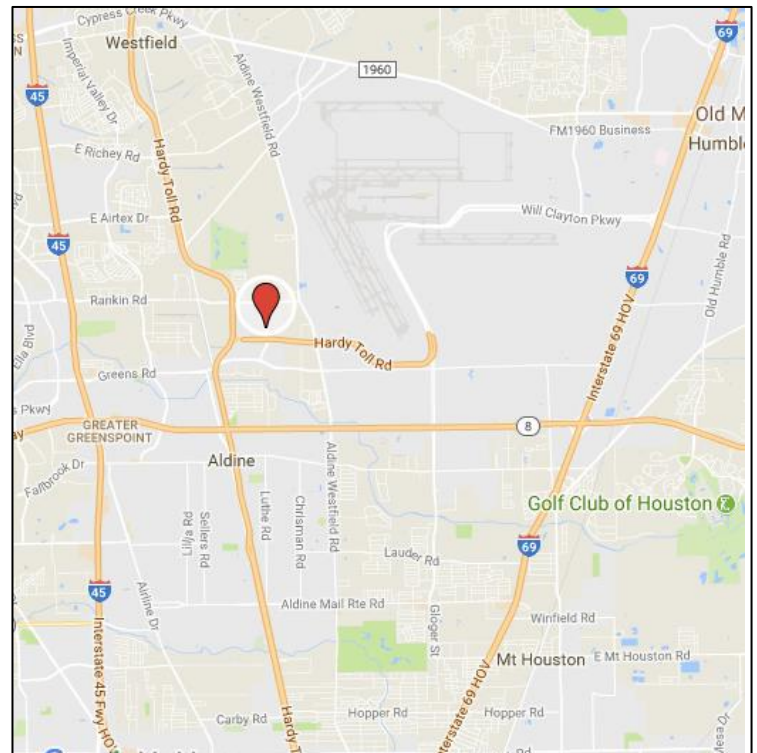

[Link: Google Maps](#)

© 2018 Brummett and Company. The information above is believed reliable. While its accuracy is not doubted, no guarantee, warranty or representation about it is hereby stated or implied. It is the responsibility of any interested party to independently confirm its accuracy and completeness. Rates quoted are "as-is" initial base rents only. Interested parties should conduct a careful, independent investigation of the properties to determine suitability.

# FOR LEASE

5,791 Total SF  
\$0.41/SF NNN

**Brummett  
& COMPANY**  
14950 Heathrow Forest Parkway, Suite 100  
Houston, Texas 77032 Tel. 281-442-5404  
LEASING@BRUMMETTANDCOMPANY.COM

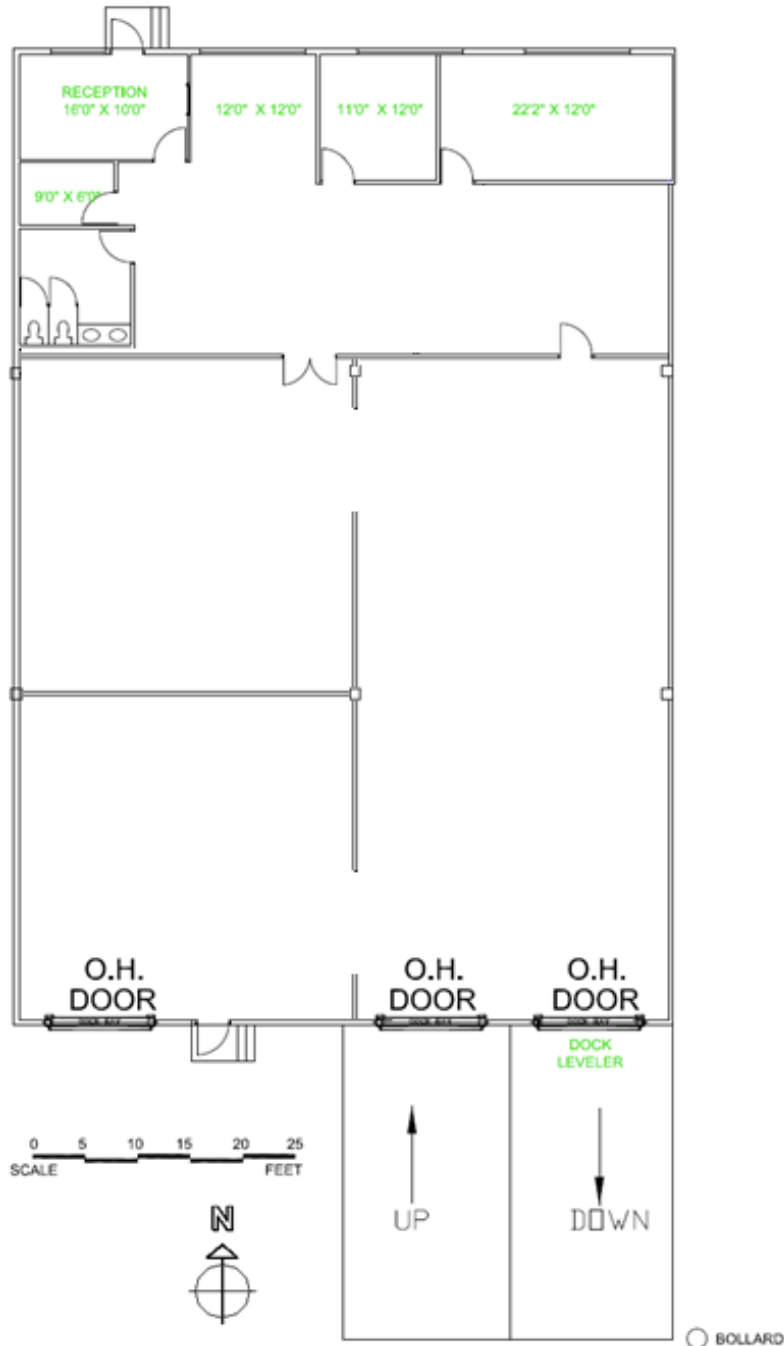

## TRANSCENTRAL BUSINESS PARK

16554 Air Center Blvd. Houston, TX 77032

© 2018 Brummett and Company. The information above is believed reliable. While its accuracy is not doubted, no guarantee, warranty or representation about it is hereby stated or implied. It is the responsibility of any interested party to independently confirm its accuracy and completeness. Rates quoted are "as-is" initial base rents only. Interested parties should conduct a careful, independent investigation of the properties to determine suitability.